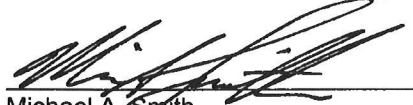

4.0 EQUIPMENT LIST

Item	Description	Supplier	Year Installed
1	<p>Trailer Enclosure System; 6' W x 10' L x 6.5' H 6" steel I beam frame, plywood floor decking, aluminum and fiberglass exterior. R-5 fiberglass wall and ceiling insulation with plywood interior. Single 3,500lb axle, 3,500lb GVWR, radial tires, 2" coupler with jack stand, electric brakes, ICC lighting. Double rear doors with cam lock and one 32" side door with camlock; (1) 12" Leader Fan Model P12 Exhaust Fan; (1) Fostoria Wall Mounted Convection Heater, Model FEP-3624 1R-A; (1) Light Fixture; (1) Switch; (1) Thermostat, (2) 12" Louvered wall shutters.</p>	<p>Paul's Bobby & Steve's Auto World 5801 Nicollet Avenue South Minneapolis, MN 55419</p>	2005
2	<p>H2K model RGN808/3 Soil Vapor Extraction System; Including aRotron EN808BA72MXL, regenerative blower capable of producing 140 icfm at 75 inches of water vacuum; 7.5 HP, 230/460-volt 3phase, EXP motor; with aluminum casting and impeller, integral inlet/outlet silencers and flexible coupling on blower inlet and outlet; (2) vacuum gauges on blower inlet; 0-60" wc vacuum (before and after filter); pressure gauge on blower discharge; 1" dilution (air bleed) PVC gate valve; temperature switch on blower discharge, Barksdale model M1LH-GH80SS; sampling port on blower inlet and discharge; Solberg CSL-851-250HC, 2.5" inline filter w/ 10 micron replacement element.</p>	<p>H2K Technologies, Inc. 9851 13th Avenue North Plymouth, MN 55441 763-746-9900</p>	2005
3	<p>Moisture Separator, Rotron 350 BS; includes Tangential inlet and float for overflow; 40-gallon total capacity; ½" Drain valve; Integral vacuum relief valve; Dwyer Flotect, model L6EPB-B-S-3-0 with high/high level switch; Welded steel construction with epoxy finish inside and out.</p>	<p>H2K Technologies, Inc. 9851 13th Avenue North Plymouth, MN 55441 763-746-9900</p>	2005
4	<p>Control Panel includes enclosure; H.O.A. switches w/ lights; starters w/ overloads; Alarm interlocks; Alarm reset button; Intrinsic safety barriers; UL listing; System interlocks and automatic control logic; System interface contacts.</p>	<p>H2K Technologies, Inc. 9851 13th Avenue North Plymouth, MN 55441 763-746-9900</p>	2005
5	<p>F.A.P. Plus™ Pump System; (3) F.A.P. Plus Pump and Filter Regulator; 1.75-inch diameter; 59-inches long; weight 6 lbs; pumping capacity of 10-15-gallons/hour at 100 feet TDH; air requirements are .5 CFM @ 100 PSIG, operating pressure 60-100 psig, suction 17-inches Mercury, Air Supply 1/4 -inch OD polyethylene, Fluid Discharge 3/8-inch ID Buna-N® hose.</p>	<p>Durham Geo Slope Indicator P.O. Box 870907 Stone Mountain, GA 30087 1-800-837-0864</p>	2005

6	F.A.P. Plus™ Skimmer; (3) 1¼-inch OD x 67-inch Long, Float UHMW Polyethylene, Specific Gravity 0.95, up to 36-inches effective travel.	Durham Geo Slope Indicator P.O. Box 870907 Stone Mountain, GA 30087 1-800-837-0864	2005
7	Quincy Model QTV-3-60 Compressor; 3hp; 10 icfm @ 135 PSI; 230/460-volt, 3 Phase; EXP motor; 60-gallon vertical ASME reservoir tank; automatic condensation drain; 5 micron coalescing filter with gage; regulator; ASCO model EF8316G64, ½" 3-way solenoid valve, NEMA 7.	H2K Technologies, Inc. 9851 13 th Avenue North Plymouth, MN 55441 763-746-9900	2005
8	Speedair Refrigerated Compressed Air Dryer; for air compressor 1.5 to 3 hp; 10 CFM capacity @ 38°F, 13 CFM @ 50°F; 1/8 refrigerated compressed hp; 115 volt, 1 phase; 3/8" inlet/outlet NPT; 15" high x 13" wide x 12" deep.	Grainger 402-476-9014	2005
9	300-gallon Above Ground Storage Tank, UL 142 Double Wall, welded steel vertical tank; 38" diameter, 60" tall; high/high level switch; vent/vacuum break with 10' extension stack.	H2K Technologies, Inc. 9851 13 th Avenue North Plymouth, MN 55441 763-746-9900	2005
10	Autodialer-Sensaphone 2000	H2K Technologies, Inc. 9851 13 th Ave. North Plymouth, MN 55441 763-746-9900	2005

Prepared by:
MILCO Environmental Services, Inc.

Michael A. Smith

1. Equipment Description

- (1) Compressor, Quincy model QTV-3-60 two stage splash lubricated reciprocating compressor
3 hp, 230/460 VAC, 3Ø, EXP motor
10 icfm capacity at 135 psi
NEMA 1 pressure switch
60 gallon vertical ASME reservoir tank
Automatic condensate drain
5 micron coalescing filter with gage
Regulator
ASCO model EF8316G64
1/2", 3-way solenoid valve, NEMA 7, to shut down pneumatic skimmers upon alarm
- (1) Product storage tank, 300 gallon, UL 142 double wall, welded steel vertical tank
38" diameter, 60" tall
High/high level switch
Vent/vacuum break with 10' extension stack
Product tank is to be mounted outside of trailer

Soil Vapor Extraction Equipment

- ~~(1) Vacuum inlet manifold with 3" main and (3) 3" takeoffs
Schedule 80 PVC header and fittings
(3) Flow control valves, 2" PVC gate valves
(3) Vacuum gages, 0-60" wc vacuum
(3) 12" clear pipe section
(3) 1/2" Sample ports~~
- (1) Moisture separator tanks, Rotron 350 BS
Tangential inlet and float for overfill
40 gallon holding capacity
Welded steel drum construction with epoxy finish inside & out
1/2" Drain valve
Integral vacuum relief valve
Dwyer Flotect L6EPB-B-S-3-0 high/high level switch

MMS 4/25/05

REVISIONS	BY

MILCO
Environmental
Services, Inc.

**FORMER NEW LEAF
REMEDIATION TRAILER
ALLIANCE, NEBRASKA
UG#: 031894-GW-1455**

SCALE: AS SHOWN
PROJECT NO. M167-P3-01
FIELD BOOK NO.
DATE: MAY, 2005
DRAWN BY: JLB
APPROVED BY:

**FIGURE
8**

Note:
1. 6 x 10 x 6.5' enclosed trailer with single 3500 lb axle, r-5 insulation and ceiling.
2. Manufacturer per spec for Class 1, Division II, Group D area, exterior considered non-classified.

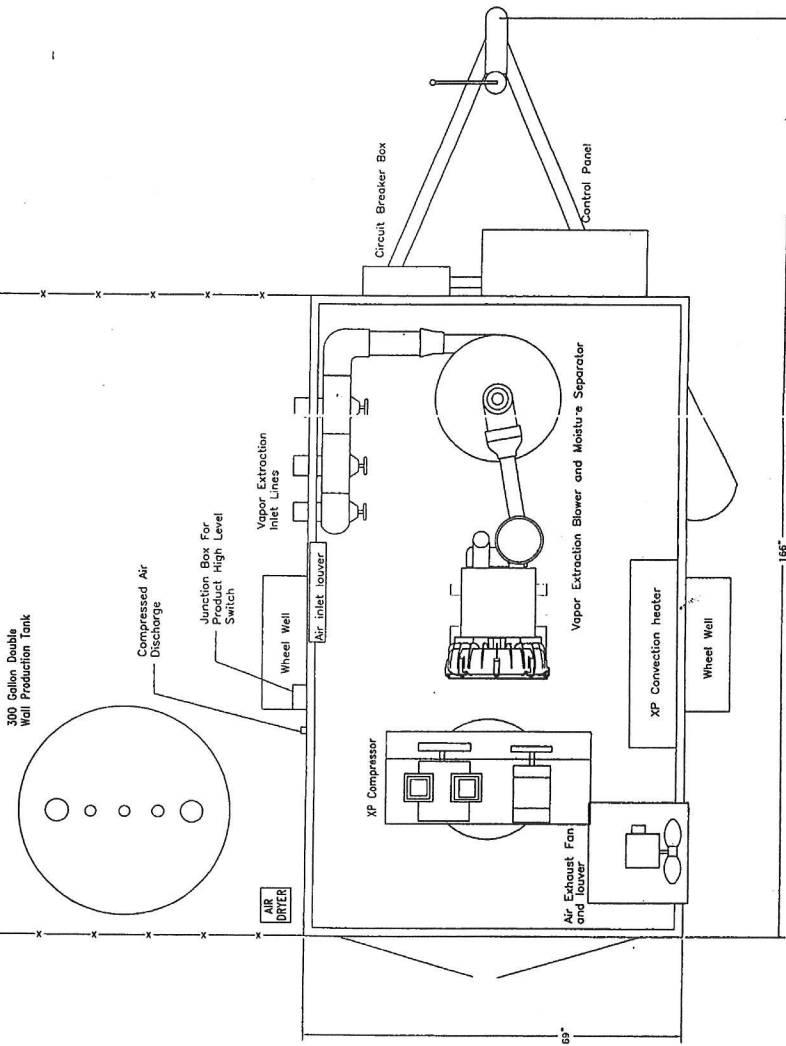

(1) H2K model RGN808/3 soil vapor extraction system

Blower, Rotron EN808BA72MXL, regenerative blower

140 icfm at 75" wc vacuum

7.5 HP, 230/460 VAC, 3Ø, EXP motor

Aluminum casing and impeller

Integral inlet/outlet silencers

Flexible coupling on blower inlet & outlet

(2) Vacuum gages on blower inlet, 0-60" wc vacuum (before & after filter)

2.5" Inline filter with 10 micron replaceable element, Solberg CSL-851-250HC

Air bleed valve, 1" PVC gate valve

Sample port on blower inlet

Temperature switch on blower discharge, Barksdale model MILH-GH80SS

Sample port on blower discharge

(1) Trailer enclosure system, 6' wide x 10' long x 6.5' high

Includes equipment installation and wiring

6" steel I beam frame

Plywood floor decking, aluminum & fiberglass exterior

R-5 fiberglass wall and ceiling insulation with plywood interior

Single 3500 lb axle, 3500lb GVWR, radial tires

2" coupler with jack stand

Electric brakes, ICC lighting

(1) Wall mounted explosion proof electric convection heater with thermostat

Fostoria model FEP-3624 1R-A

(1) Ceiling mounted explosion proof light with wall switch

(1) Explosion proof vent fan with inlet & outlet louvers and thermostat

Leader Fan model P12

Double rear doors with camlock

(1) 32" side door with camlock

control panel will be mounted, and wired on outside of trailer for a non-classified area. SVE & compressor will be mounted piped and wired in SVE room. Piping will be schedule 40 galvanized for compressed air and SVE discharge, Schedule 80 PVC for SVE inlet. Wiring will be per NEC for Class I, Div II Group D hazardous environment inside the trailer and for a non-classified area outside the trailer beyond 5' from any opening.

Note:
 1. 6'x10'x6.5' enclosed trailer with single 3500 lb axle, R-5 insulation walls and ceiling.
 2. Interior wired per NEC for Class I, Division II, Group D area, exterior considered non-classified.

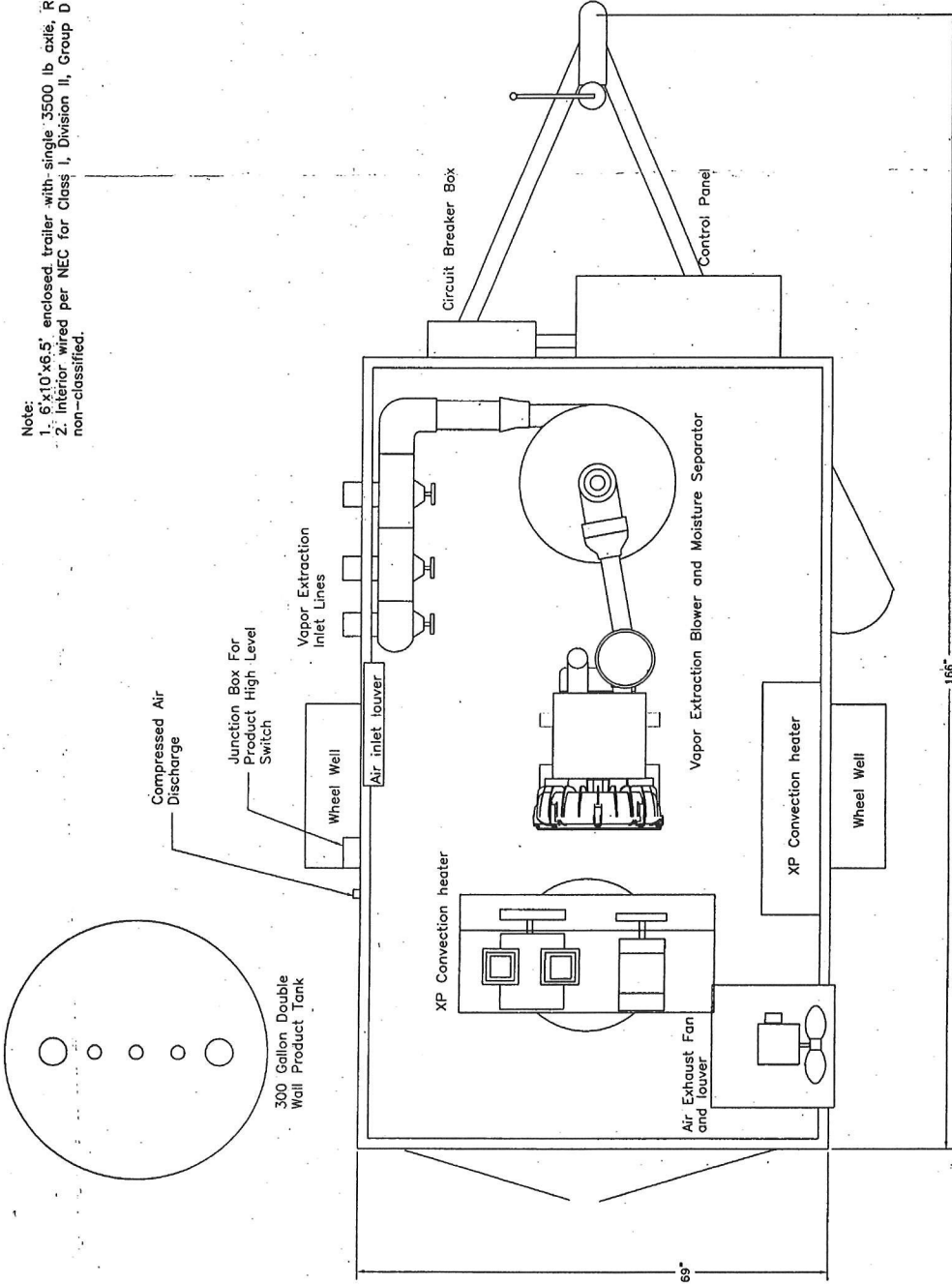

SHEET 1 OF 1
 DRAWING NO:
 1381-02

DRAWING TITLE:
 SVE & Compressor
 Layout Drawing

PROJECT TITLE:
 MILCO
 NEW LEAF
 ALLIANCE, NE



9851 13th Ave N., Plymouth, MN 55441, Tel: 763-746-9900 ©2002

THESE MATERIALS ARE PROPRIETARY OF H2K TECHNOLOGIES, INC. BUYER SHALL HAVE THE USE OF MATERIALS AND INFORMATION FOR THE LIMITED PURPOSE OF INSTALLING AND MAINTAINING EQUIPMENT MANUFACTURED BY H2K TECHNOLOGIES, INC. NOT TO BE REPRODUCED WITHOUT WRITTEN PERMISSION.

UNLESS SPECIFIED OTHERWISE
 ALL DIMENSIONS ARE IN INCHES
 • DO NOT SCALE DRAWING
 DRAWN BY: MK
 DESIGNED BY: MK
 PROJECT MGR: MK
 DATE: 1/5/03
 PROJECT NO.: 1381

DATE DWN: 1/5/03
 DESCRIPTION: R V N N

3. Control Panel Schematics and Description

Scope

The controls were provided by H2K Technologies, Inc. for the MILCO-New Leaf-Alliance, NE/#1381 site. This section on controls is provided as a descriptive summary of the P & ID. This section can be used to determine the conditions which must be met for each item to operate.

General

- Any switch in the "HAND" position will operate the corresponding circuit under any alarm condition, except for a motor temperature fault or a circuit overload. The "HAND" position is for diagnostics or to clear alarms. The system should never be left unattended while any switch is in the "HAND" position.
- To reset an alarm, switch all switches to the "OFF" position. Clear the cause of the alarm condition. Then press the "RESET" button. If the panel will not reset, then an alarm condition still exists.
- Upon powering the panel, alarm lights may be lit. The panel may require to be reset every time power is disconnected.

In the "AUTO" position

Item	Required conditions
Air Compressor AC-100	Integral Start/Stop PSH-100 determines when AC-100 is required to run. Product Tank LAH-100 must NOT exist. The corresponding circuit breaker or overload must NOT be tripped.
Air Compressor Solenoid Valve SV-100	Product Tank LAH-100 must NOT exist. The corresponding circuit breaker or overload must NOT be tripped.
Vapor Extraction Blower B-200	Moisture Separator LAH-200 must NOT exist. Vapor Extraction Blower TAH-200 must NOT exist. The corresponding circuit breaker or overload must NOT be tripped.

Alarm Description

Control Device	Resultant Condition	Control Panel Indication
Product Tank LSH-100	Shuts down Air Compressor AC-100 Shuts down Solenoid Valve SV-100	Product Tank LAH-100 pilot light illuminates
Moisture Separator LSH-200	Shuts down Vapor Extraction Blower B-200	Moisture Separator LAH-200 pilot light illuminates
Vapor Extraction Blower TSH-200	Shuts down Vapor Extraction Blower B-200	Vapor Extraction Blower TAH-200 pilot light illuminates

Blower Performance Curves

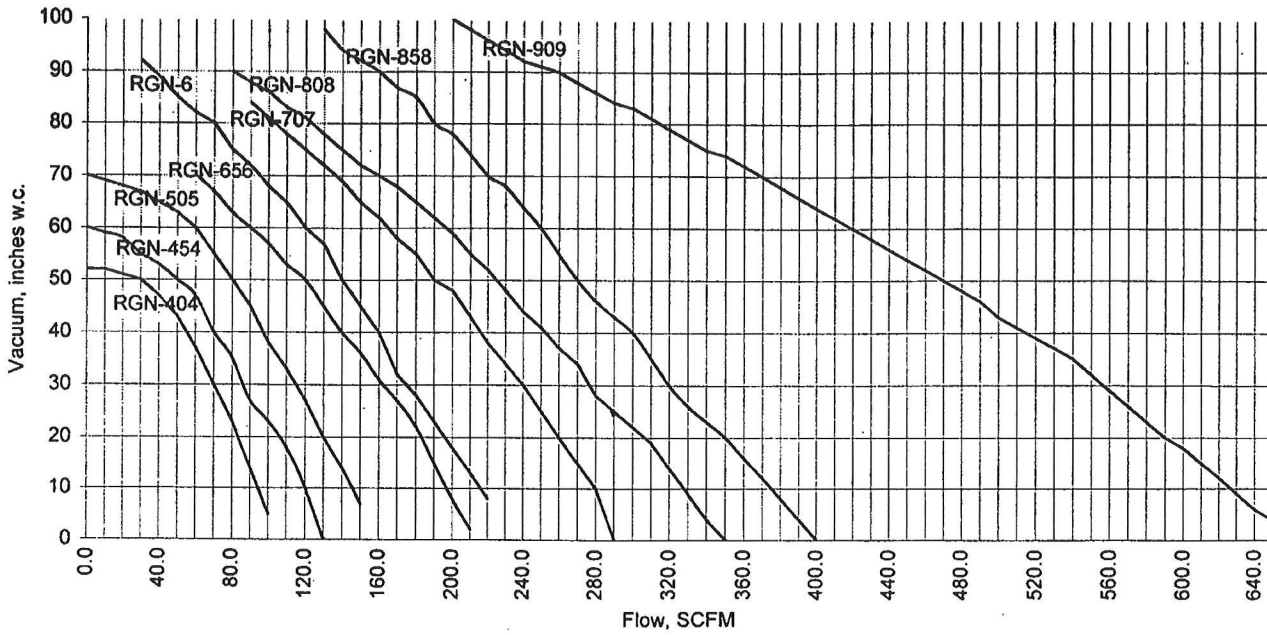

Blower performance curves

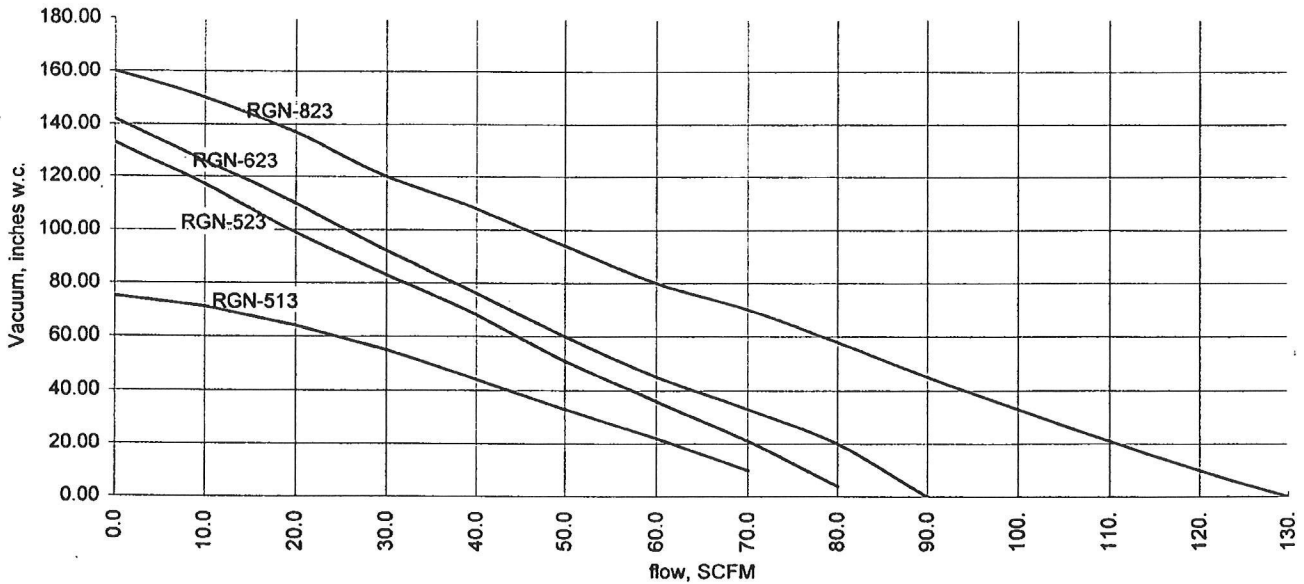

Installation

- Set the system in place using the properly sized lifting equipment. Anchor the system in place per the site specifications.
- Connect the influent and effluent piping to the system.
 - It is recommended to use a flex connector on both the influent and effluent piping connections. The piping connected to the system should be self-supporting.
 - The discharge piping of the blower will be hot. It is recommended to use steel piping on the discharge for a long enough run to allow the air to cool down.
 - A pressure relief valve can also be installed on the effluent piping to prevent the system from over-amping the motor.